

Features:

- 9200-16150 MHz
- 50 Ohm to 2 x 50 Ohm
- 5G Applications
- Very Low Loss
- Tight Amplitude Balance
- Input to Output DC Isolation
- Production Friendly
- Tape and Reel
- Non-conductive Surface
- RoHS Compliant
- Halogen Free

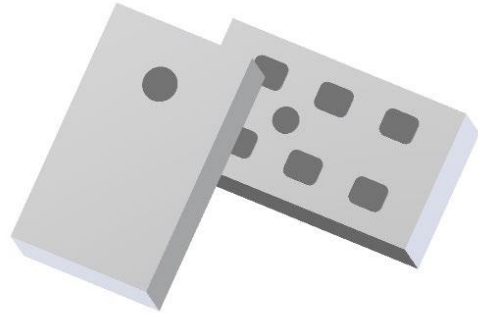

Electrical Specifications

Parameter	Min.	Typ.	Max	Min.	Typ.	Max	Unit
Frequency	9200		14000	14000		16150	MHz
Unbalanced Port Impedance		50			50		Ohm
Balanced Port Impedance		100			100		Ohm
Return Loss	18			16			dB
Insertion Loss			0.7			1.0	dB
Amplitude Balance			±1.0			±1.0	dB
Phase Balance			±9			±12	Degrees
CMRR		20			16		dB
Power (Avg. Watts @105°C)		1			1		Watts
Operating Temperature	-55		+140	-55		+140	°C

Outline Drawing:

